

FOX EQUINE BARN

Modular Barns, Shelters & Fencing Solutions

2 Stall, 4 Rail

BREEZEWAY

BARN Starting at
\$2,500

Paddocks / Runs

5' Tall x 12' Wide 4 Rail Panel
at \$120 each



Plywood Ready Walls

7' Tall x 12' Wide Wall
(Plywood & Hardware Extra)
starting at \$50

Breezeway Barns With Covered Aisle

12'x12' stalls with 12' wide covered center aisle,
including clamps & self tapping roof screws.

Shelters are 8' tall gate front, sloping to 7' tall rear,
4 rail walls on 3 sides with 4 rail gate front, breezeway is 8.5' at center.

All of the steel tubing is heavy 16 gauge galvanized 1 5/8" tubing with welds 360 degree around so they won't rust or bend easily like other cheaper thinner panels. Barns & shelters are completely modular so you can always add onto them with additional 12x12 stalls or tack/grain/hay rooms.

Technical Specs

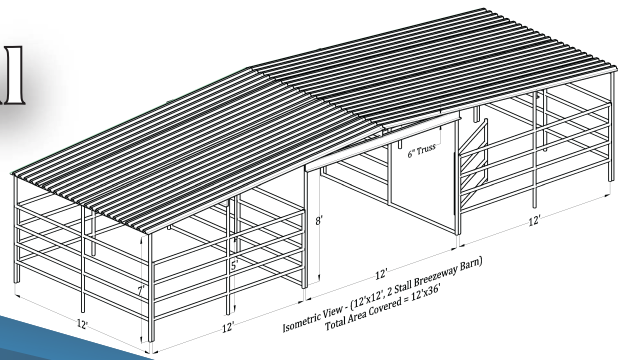

Delivery and complete set up available,

Contact us for a quote

All prices subject to change without notice, prices do not include cost of plywood.

All shelters are free standing unless otherwise requested, wind anchors can be provided at an additional charge.

Unless otherwise requested, all shelters will be installed as pictured.

PROFESSIONALISM

Fox Equine Barns was founded in 2015, when our horse rescue, Fox Equine Rescue & Youth Horsemanship Center, moved and needed fencing and shelters for our 15 rescue horses. We couldn't find what we needed at an affordable price, so we started a business to manufacture and sell livestock shelters, barns, corral panels, round pens, and gates.

Front Elevation (12'x12', 2 Stall Breezeway Barn)

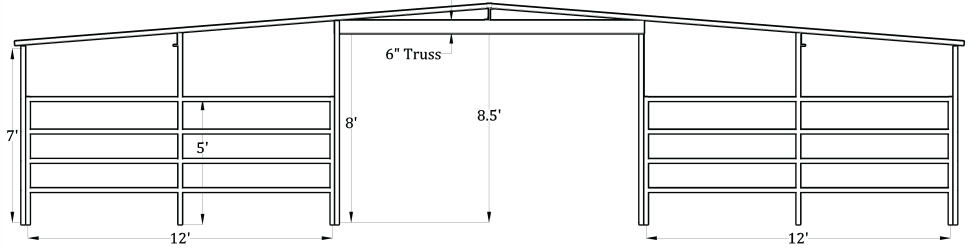

Top View (12'x12', 2 Stall Breezeway Barn)
Total Area Covered = 12'x36'

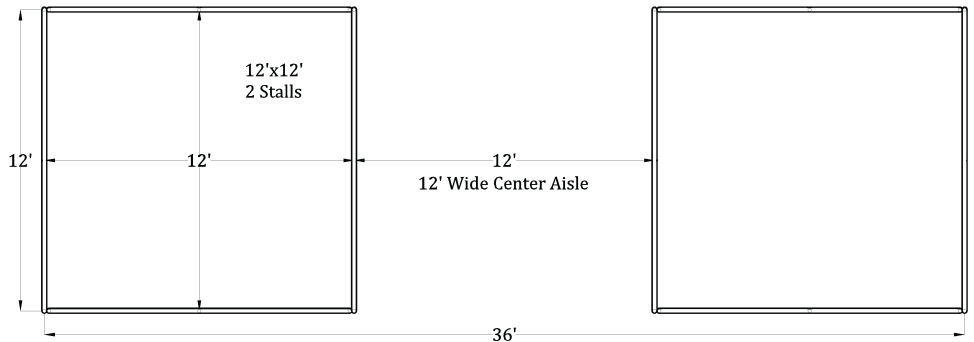

Side View (12'x12', 2 Stall Breezeway Barn)

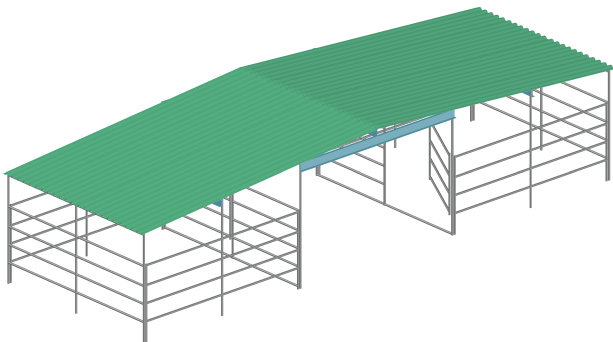
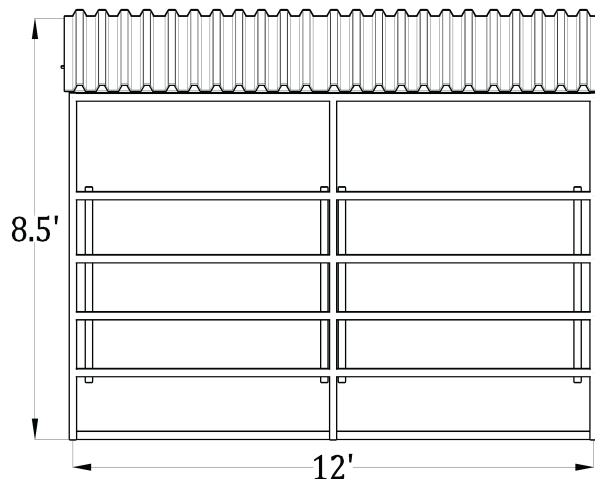

FOX EQUINE BARN

Modular Barns, Shelters & Fencing Solutions

4 Stall, 4 Rail

**BREEZEWAY
BARN** Starting at
\$4,900

Paddocks / Runs

5' Tall x 12' Wide 4 Rail Panel
at \$120 each



Plywood Ready Walls

7' Tall x 12' Wide Wall
(Plywood & Hardware Extra)
starting at \$50

Breezeway Barns With Covered Aisle

12'x12' stalls with 12' wide covered center aisle,
including clamps & self tapping roof screws.

Shelters are 8' tall gate front, sloping to 7' tall rear,
4 rail walls on 3 sides with 4 rail gate front, breezeway is 8.5' at center.

All of the steel tubing is heavy 16 gauge galvanized 1 5/8" tubing with welds 360 degree around so they won't rust or bend easily like other cheaper thinner panels. Barns & shelters are completely modular so you can always add onto them with additional 12x12 stalls or tack/grain/hay rooms.

408-416-6602

FoxEquineBarns@gmail.com

<http://foxequinebarns.com/>

Technical Specs

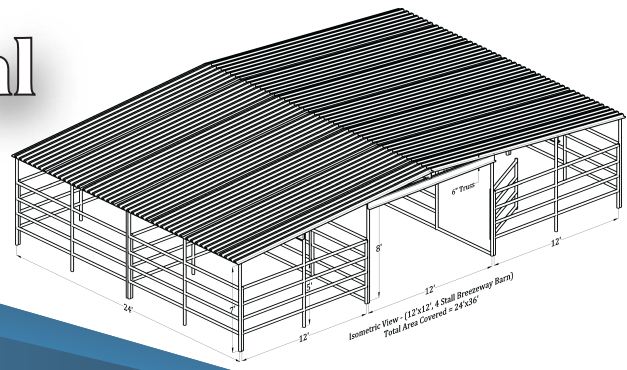

Delivery and complete set up available,

Contact us for a quote

All prices subject to change without notice, prices do not include cost of plywood.

All shelters are free standing unless otherwise requested, wind anchors can be provided at an additional charge.

Unless otherwise requested, all shelters will be installed as pictured.

PROFESSIONALISM

Fox Equine Barns was founded in 2015, when our horse rescue, Fox Equine Rescue & Youth Horsemanship Center, moved and needed fencing and shelters for our 15 rescue horses. We couldn't find what we needed at an affordable price, so we started a business to manufacture and sell livestock shelters, barns, corral panels, round pens, and gates.

Front Elevation (12'x12', 4 Stall Breezeway Barn)

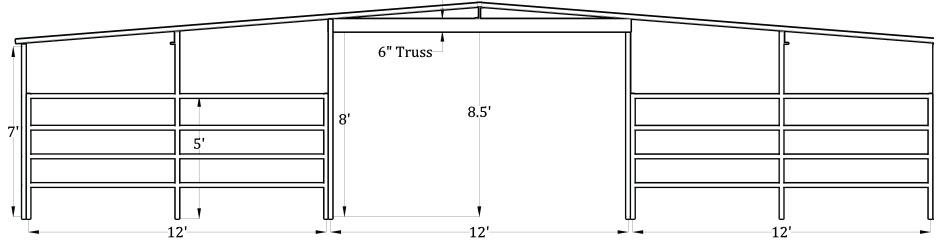

Top View (12'x12', 4 Stall Breezeway Barn)
Total Area Covered = 24'x36'

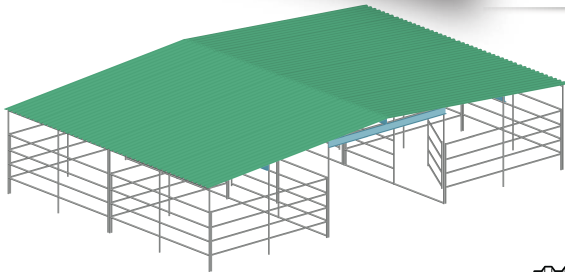
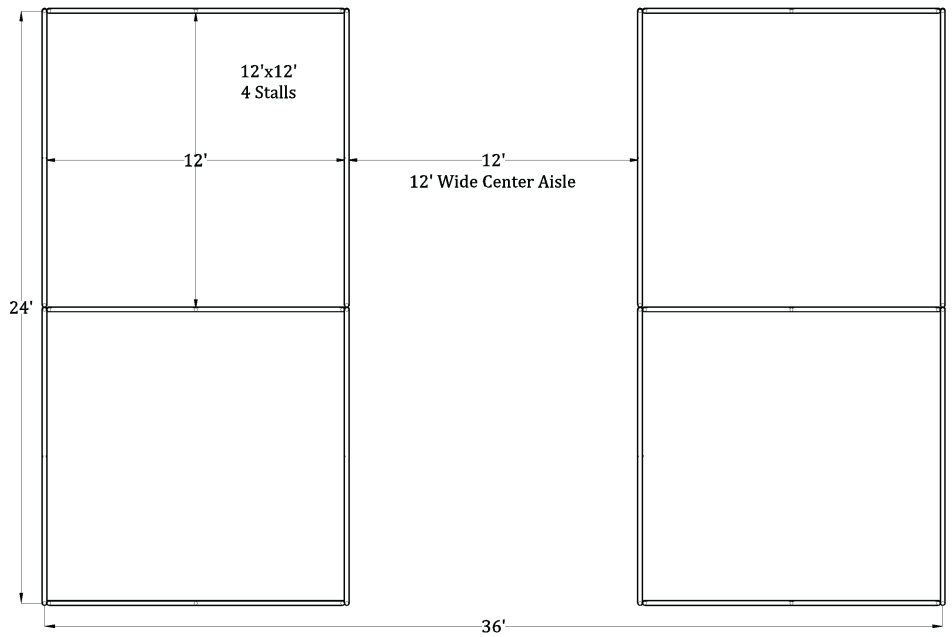

Side View (12'x12', 4 Stall Breezeway Barn)

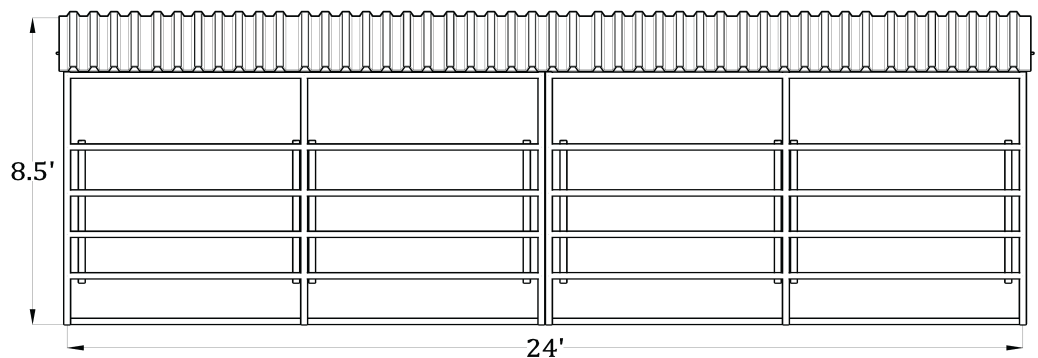

FOX EQUINE BARN

Modular Barns, Shelters & Fencing Solutions

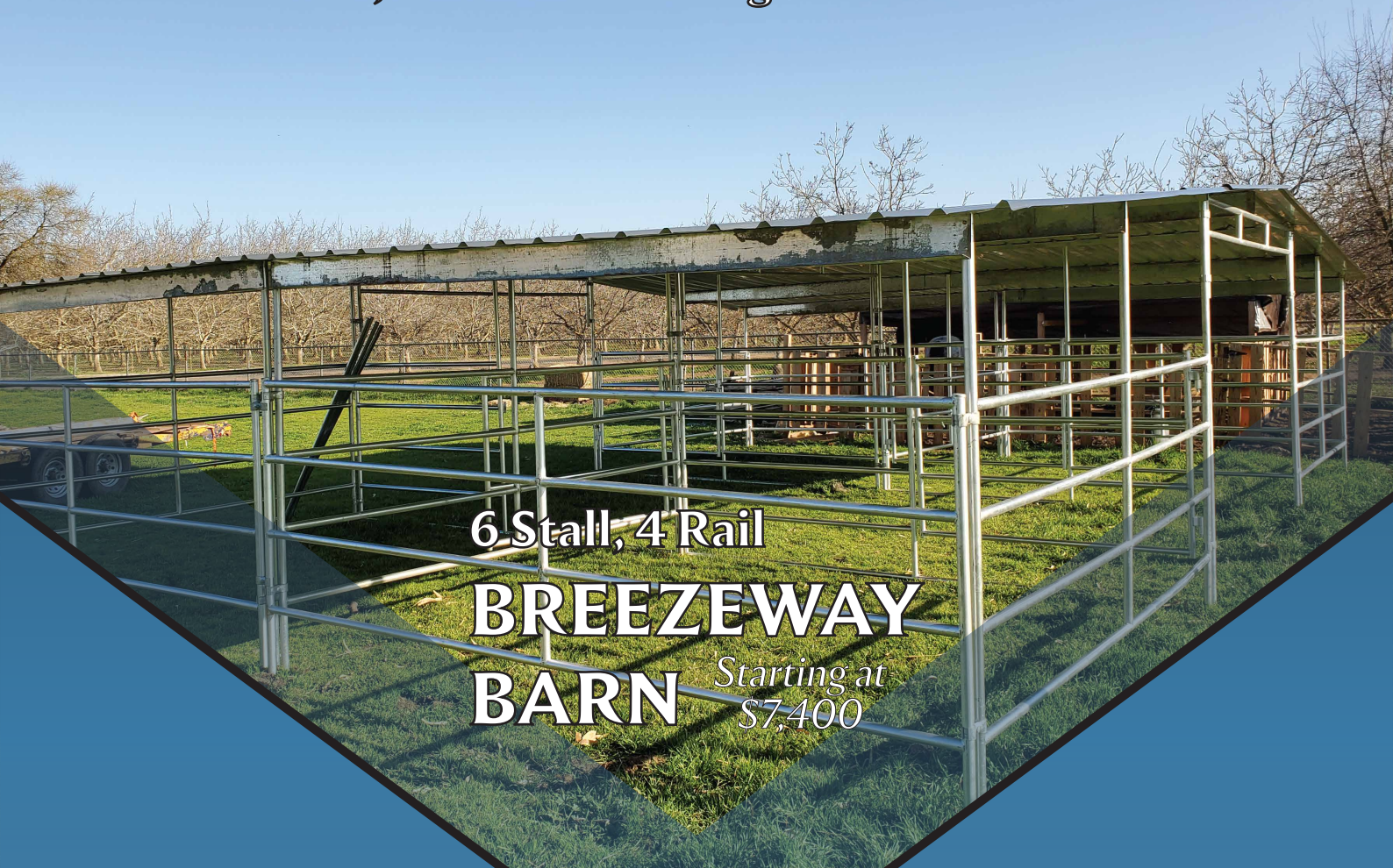

6 Stall, 4 Rail

**BREEZEWAY
BARN** Starting at
\$7,400

Paddocks / Runs

5' Tall x 12' Wide 4 Rail Panel
at \$120 each

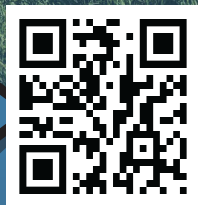

Plywood Ready Walls

7' Tall x 12' Wide Wall
(Plywood & Hardware Extra)
starting at \$50

Breezeway Barns With Covered Aisle

12'x12' stalls with 12' wide covered center aisle,
including clamps & self tapping roof screws.

Shelters are 8' tall gate front, sloping to 7' tall rear,
4 rail walls on 3 sides with 4 rail gate front, breezeway is 8.5' at center.

All of the steel tubing is heavy 16 gauge galvanized 1 5/8" tubing with welds 360 degree around so they won't rust or bend easily like other cheaper thinner panels. Barns & shelters are completely modular so you can always add onto them with additional 12x12 stalls or tack/grain/hay rooms.

Technical Specs

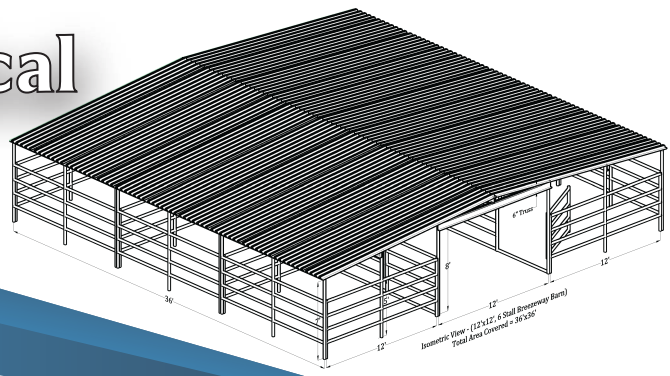

Delivery and complete set up available,

Contact us for a quote

All prices subject to change without notice, prices do not include cost of plywood.

All shelters are free standing unless otherwise requested, wind anchors can be provided at an additional charge.

Unless otherwise requested, all shelters will be installed as pictured.

PROFESSIONALISM

Fox Equine Barns was founded in 2015, when our horse rescue, Fox Equine Rescue & Youth Horsemanship Center, moved and needed fencing and shelters for our 15 rescue horses. We couldn't find what we needed at an affordable price, so we started a business to manufacture and sell livestock shelters, barns, corral panels, round pens, and gates.

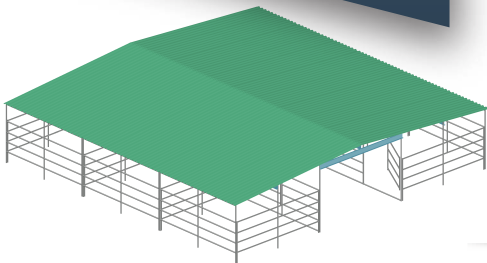

Front Elevation (12'x12', 6 Stall Breezeway Barn)

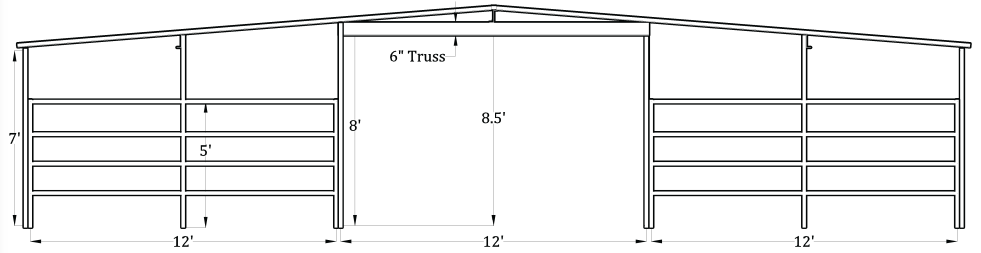

Top View (12'x12', 6 Stall Breezeway Barn)
Total Area Covered = 36'x36'

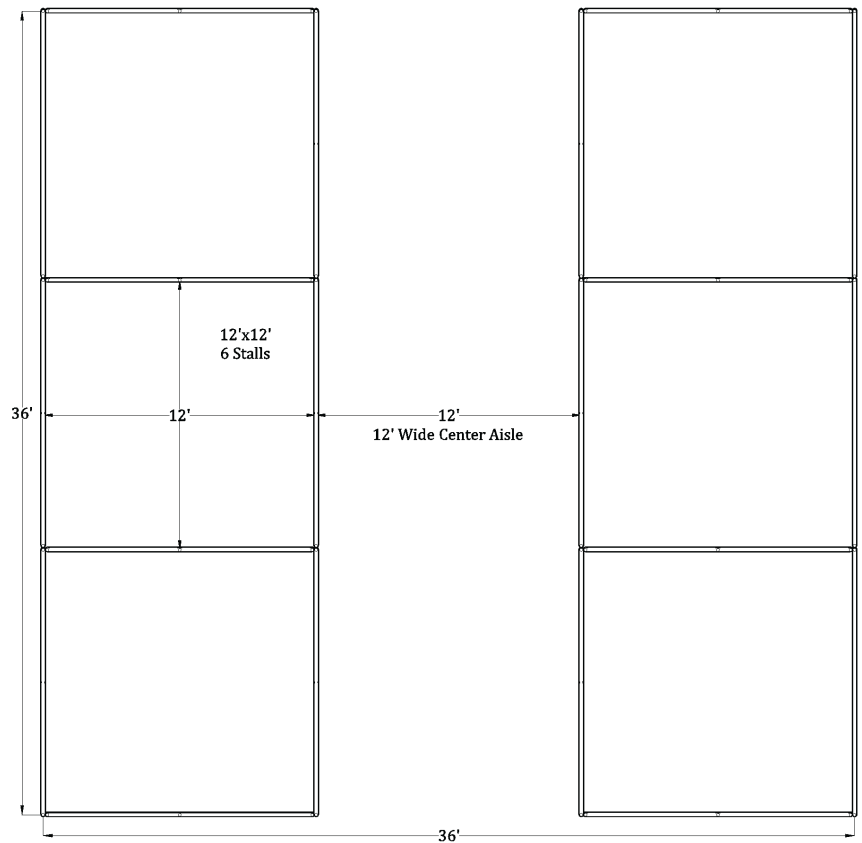

Side View (12'x12', 6 Stall Breezeway Barn)

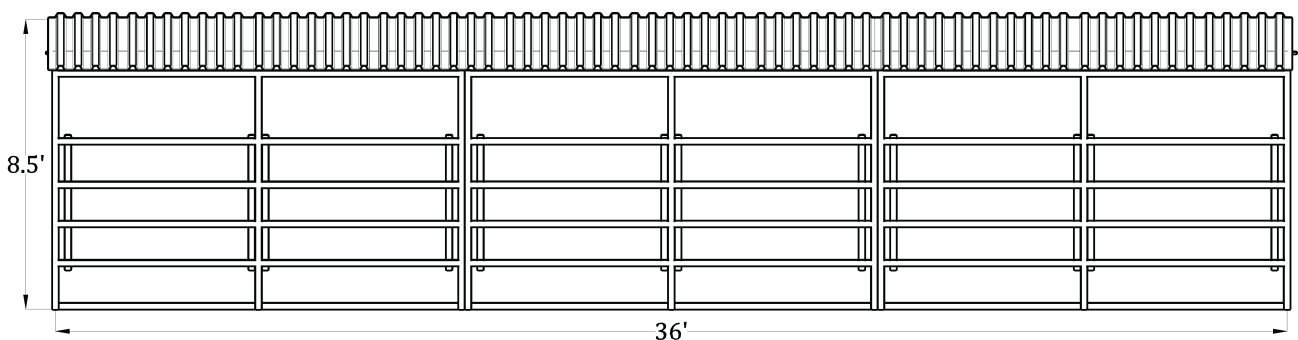

FOX EQUINE BARN

Modular Barns, Shelters & Fencing Solutions



8 Stall, 4 Rail

BREEZEWAY

BARN

Starting at
\$9,900

Paddocks / Runs

5' Tall x 12' Wide 4 Rail Panel
at \$120 each



Plywood Ready Walls

7' Tall x 12' Wide Wall
(Plywood & Hardware Extra)
starting at \$50

Breezeway Barns With Covered Aisle

12'x12' stalls with 12' wide covered center aisle,
including clamps & self tapping roof screws.

Shelters are 8' tall gate front, sloping to 7' tall rear,
4 rail walls on 3 sides with 4 rail gate front, breezeway is 8.5' at center.

All of the steel tubing is heavy 16 gauge galvanized 1 5/8" tubing with welds 360 degree around so they won't rust or bend easily like other cheaper thinner panels. Barns & shelters are completely modular so you can always add onto them with additional 12x12 stalls or tack/grain/hay rooms.

408-416-6602

FoxEquineBarns@gmail.com

<http://foxequinebarns.com/>

Technical Specs

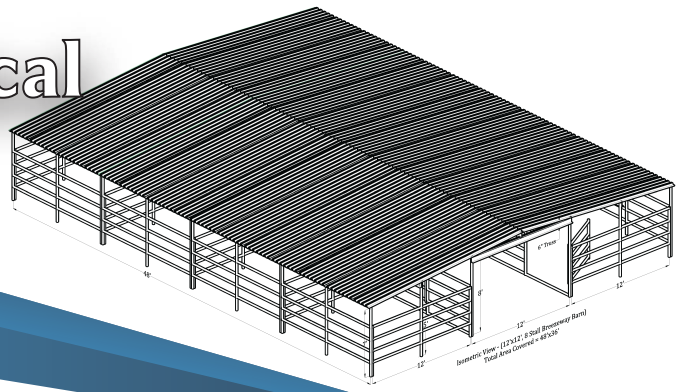

Delivery and complete set up available,

Contact us for a quote

All prices subject to change without notice, prices do not include cost of plywood.

All shelters are free standing unless otherwise requested, wind anchors can be provided at an additional charge.

Unless otherwise requested, all shelters will be installed as pictured.

PROFESSIONALISM

Fox Equine Barns was founded in 2015, when our horse rescue, Fox Equine Rescue & Youth Horsemanship Center, moved and needed fencing and shelters for our 15 rescue horses. We couldn't find what we needed at an affordable price, so we started a business to manufacture and sell livestock shelters, barns, corral panels, round pens, and gates.

Front Elevation (12'x12', 8 Stall Breezeway Barn)

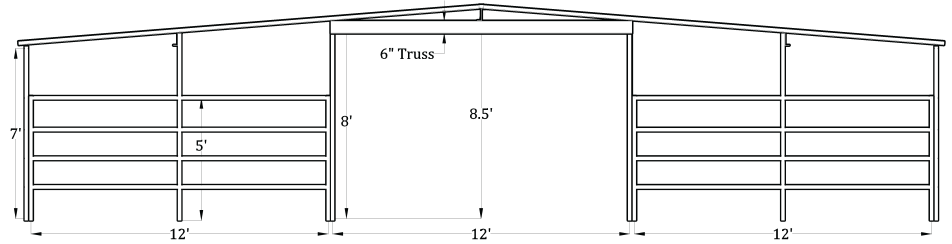

Top View (12'x12', 8 Stall Breezeway Barn)
Total Area Covered = 48'x36'

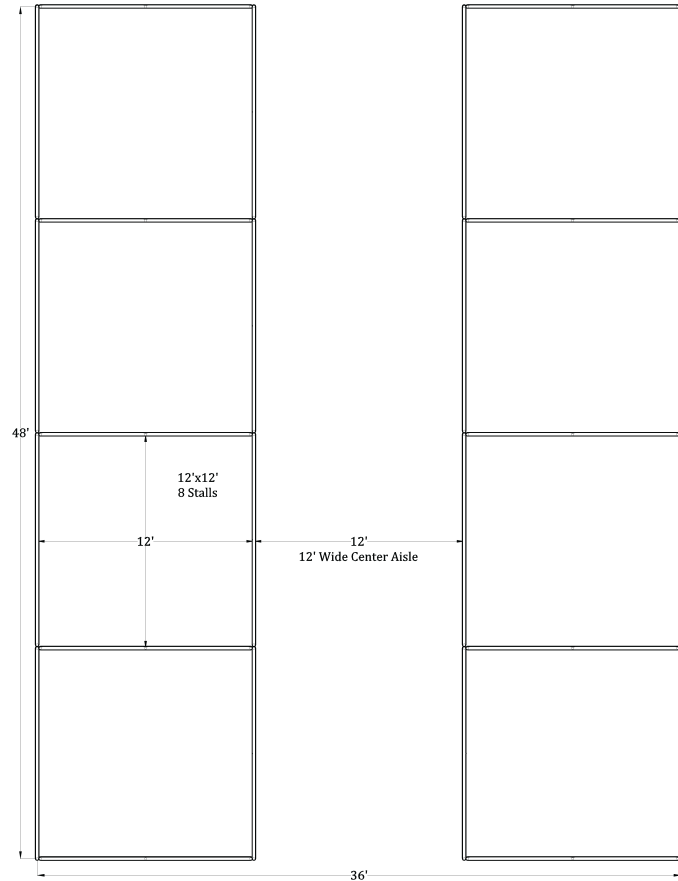

Side View (12'x12', 8 Stall Breezeway Barn)

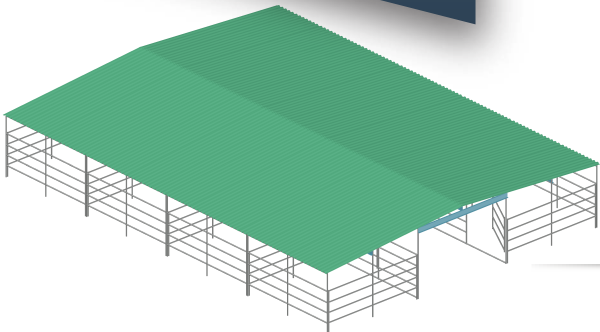
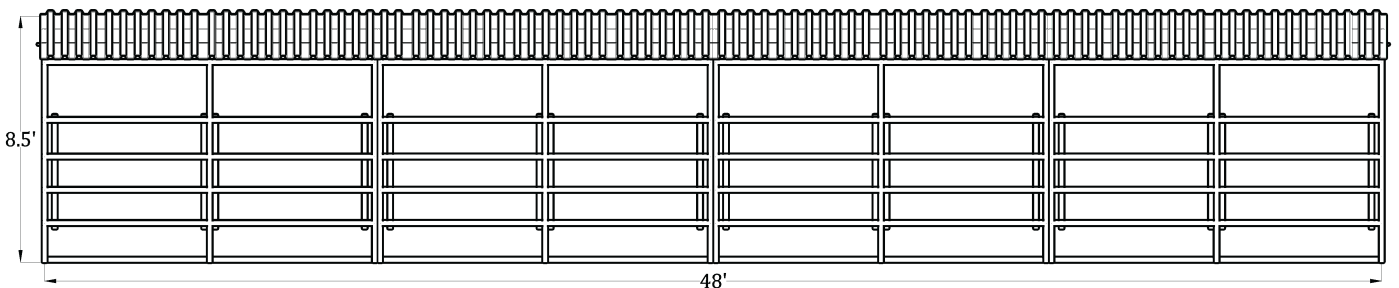

FOX EQUINE BARN

Modular Barns, Shelters & Fencing Solutions

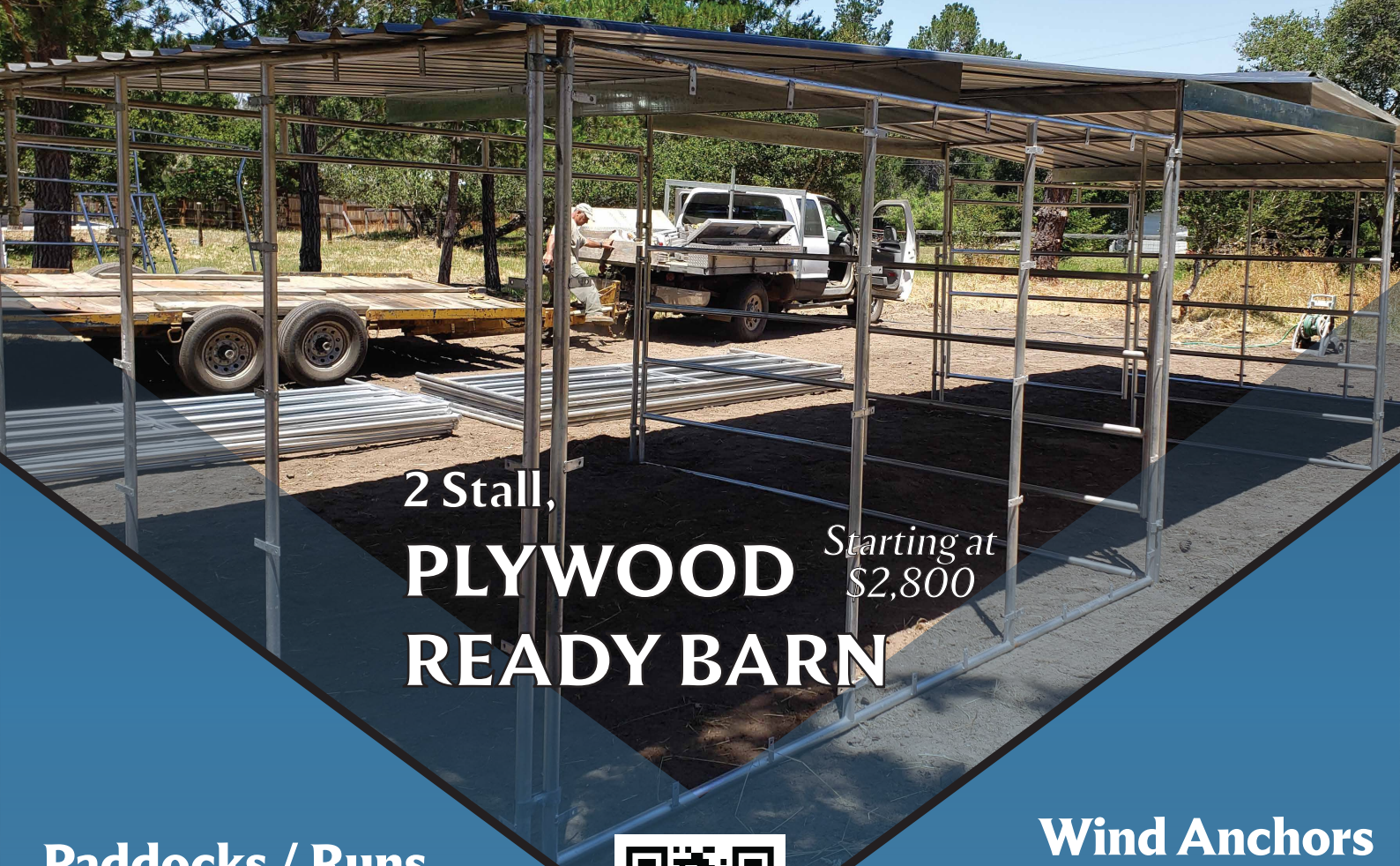

2 Stall,

PLYWOOD READY BARN

Starting at
\$2,800

Paddocks / Runs

5' Tall x 12' Wide 4 Rail Panel
at \$120 each



Wind Anchors

7', 1 5/8 Galvanized Steel Pole
With Clamps
at \$30 each

Plywood Ready Barns With Covered Aisle

Our standard shelters and barns with plywood ready sides use 12 foot panels that are 7 feet tall that have vertical tubes with tabs welded onto them that the plywood bolts onto with 3/8 inch hardware.

3 sheets of plywood fit recessed inside each bay in the 12 foot wide panel, when they are cut down to 7 feet tall. Each sheet of plywood The panels are made from the same 1 5/8 inch galvanized steel tubing.

Barns & shelters are completely modular so you can always add onto them with additional 12x12 stalls or tack/grain/hay rooms.

Technical Specs

Delivery and complete set up available,

Contact us for a quote

All prices subject to change without notice, prices do not include cost of plywood.

All shelters are free standing unless otherwise requested, wind anchors can be provided at an additional charge.

Unless otherwise requested, all shelters will be installed as pictured.

PROFESSIONALISM

Fox Equine Barns was founded in 2015, when our horse rescue, Fox Equine Rescue & Youth Horsemanship Center, moved and needed fencing and shelters for our 15 rescue horses. We couldn't find what we needed at an affordable price, so we started a business to manufacture and sell livestock shelters, barns, corral panels, round pens, and gates.

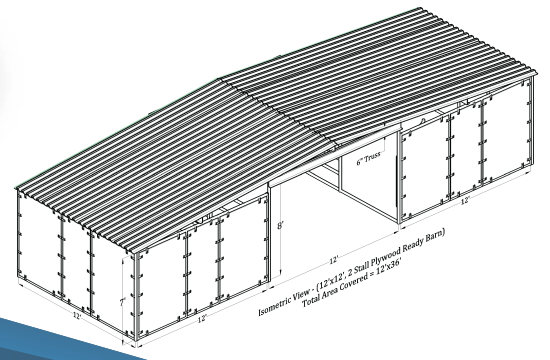

Front Elevation (12'x12', 2 Stall Plywood Ready Barn)

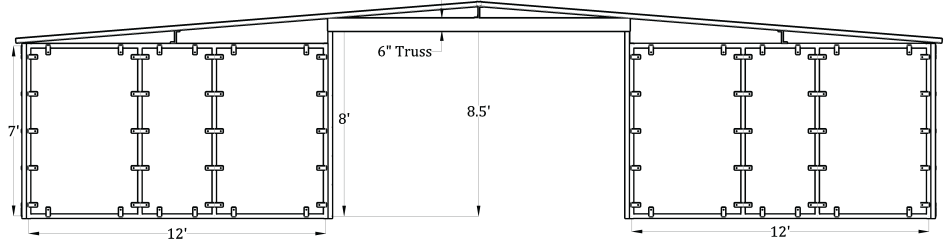

Top View (12'x12', 2 Stall Plywood Ready Barn)

Total Area Covered = 12'x36'

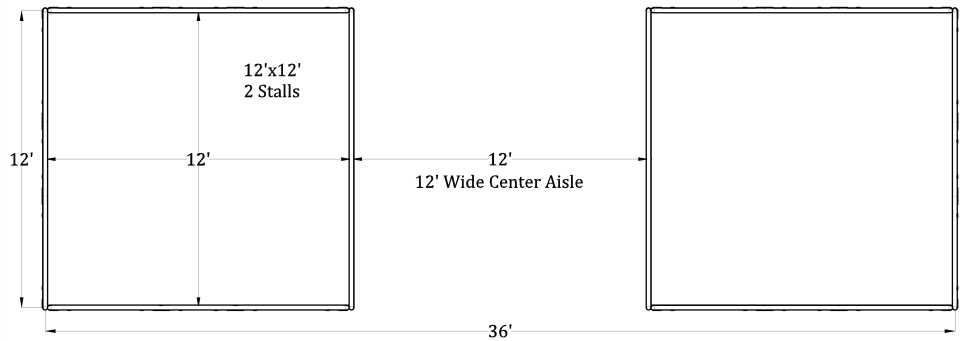

Side View (12'x12', 2 Stall Plywood Ready Barn)

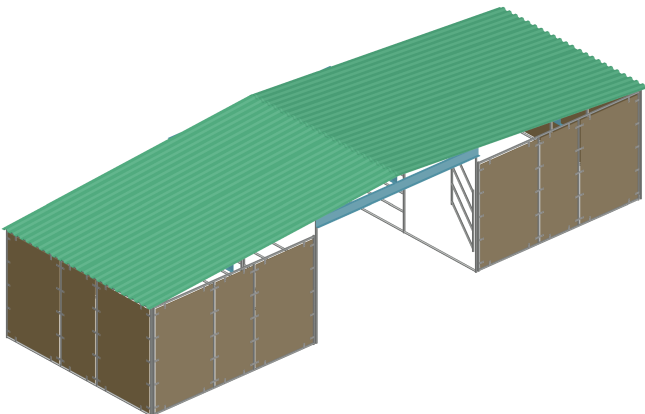
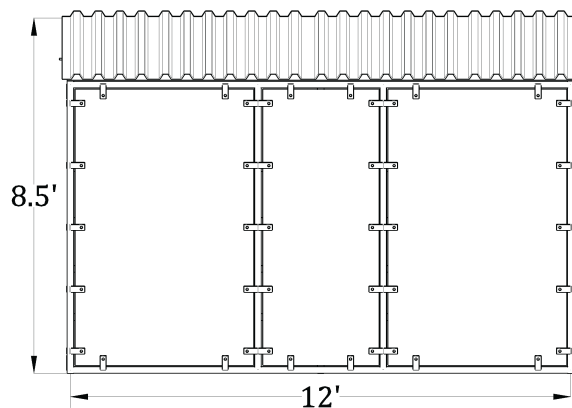

FOX EQUINE BARN

Modular Barns, Shelters & Fencing Solutions

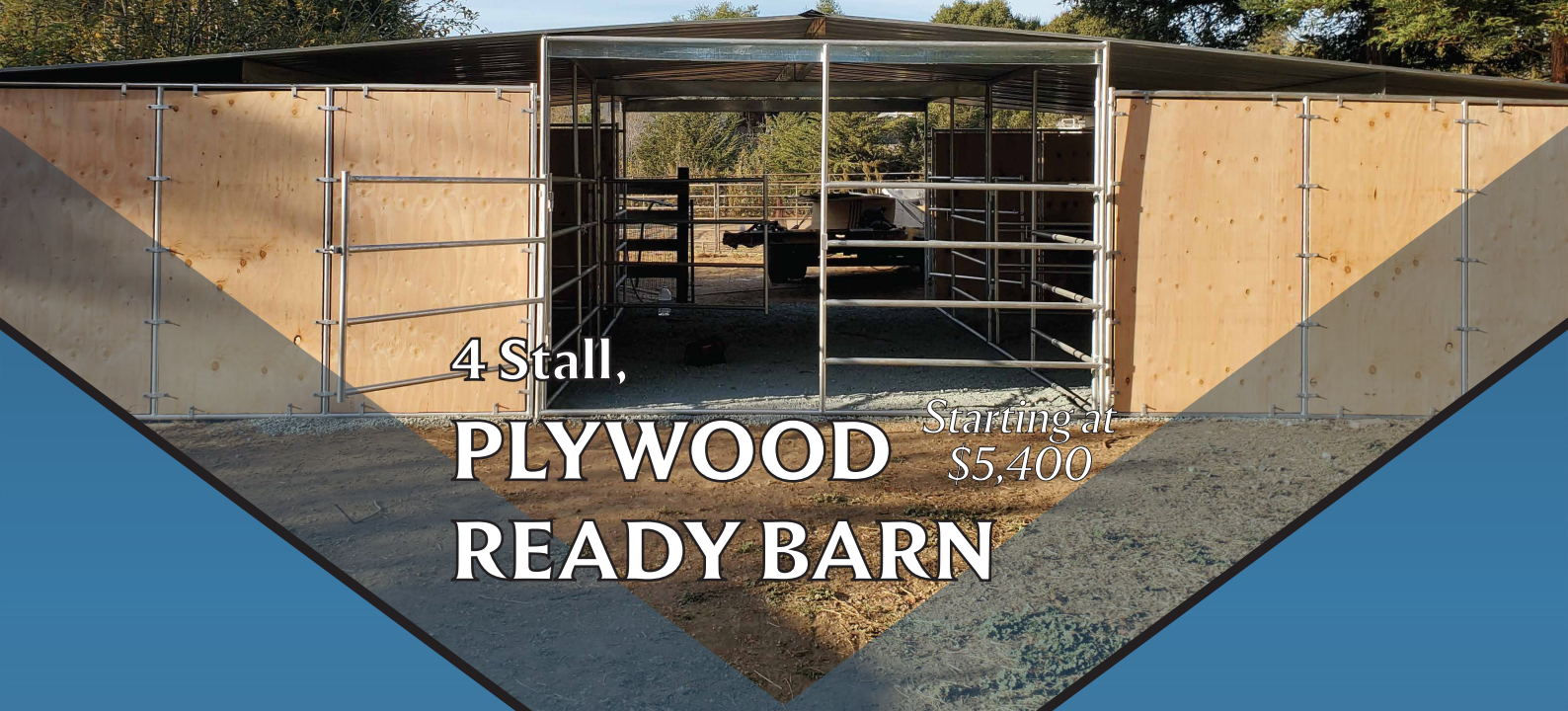

4 Stall,

**PLYWOOD
READY BARN**

Starting at
\$5,400

Paddocks / Runs

5' Tall x 12' Wide 4 Rail Panel
at \$120 each

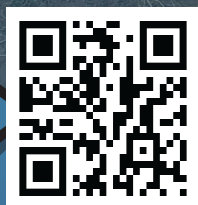

Wind Anchors

7', 1 5/8 Galvanized Steel Pole
With Clamps
at \$30 each

Plywood Ready Barns With Covered Aisle

Our standard shelters and barns with plywood ready sides use 12 foot panels that are 7 feet tall that have vertical tubes with tabs welded onto them that the plywood bolts onto with 3/8 inch hardware.

3 sheets of plywood fit recessed inside each bay in the 12 foot wide panel, when they are cut down to 7 feet tall. Each sheet of plywood The panels are made from the same 1 5/8 inch galvanized steel tubing.

Barns & shelters are completely modular so you can always add onto them with additional 12x12 stalls or tack/grain/hay rooms.

Technical Specs

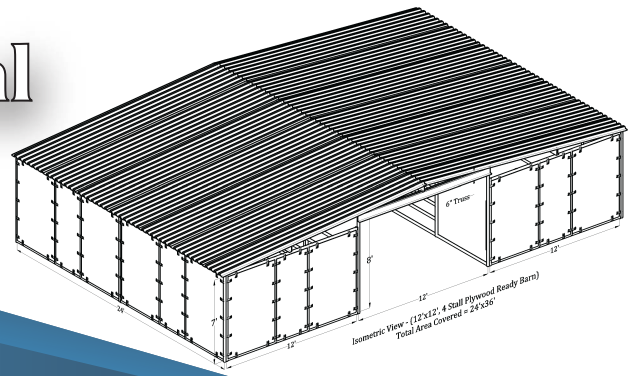

Delivery and complete set up available,

Contact us for a quote

All prices subject to change without notice, prices do not include cost of plywood.

All shelters are free standing unless otherwise requested, wind anchors can be provided at an additional charge.

Unless otherwise requested, all shelters will be installed as pictured.

PROFESSIONALISM

Fox Equine Barns was founded in 2015, when our horse rescue, Fox Equine Rescue & Youth Horsemanship Center, moved and needed fencing and shelters for our 15 rescue horses. We couldn't find what we needed at an affordable price, so we started a business to manufacture and sell livestock shelters, barns, corral panels, round pens, and gates.

Front Elevation (12'x12', 4 Stall Plywood Ready Barn)

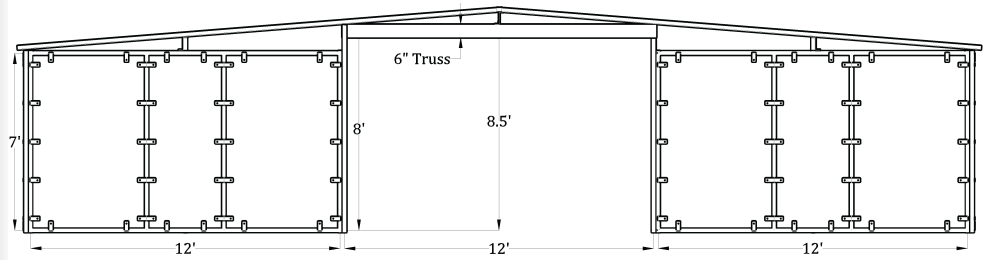

Top View (12'x12', 4 Stall Plywood Ready Barn)
Total Area Covered = 24'x36'

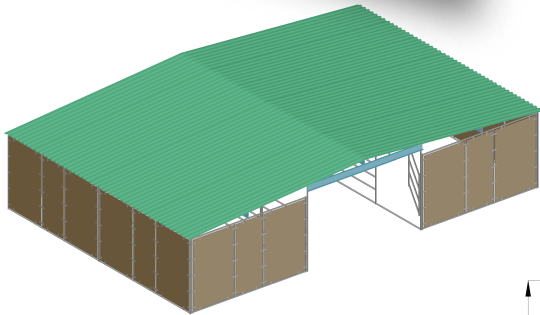
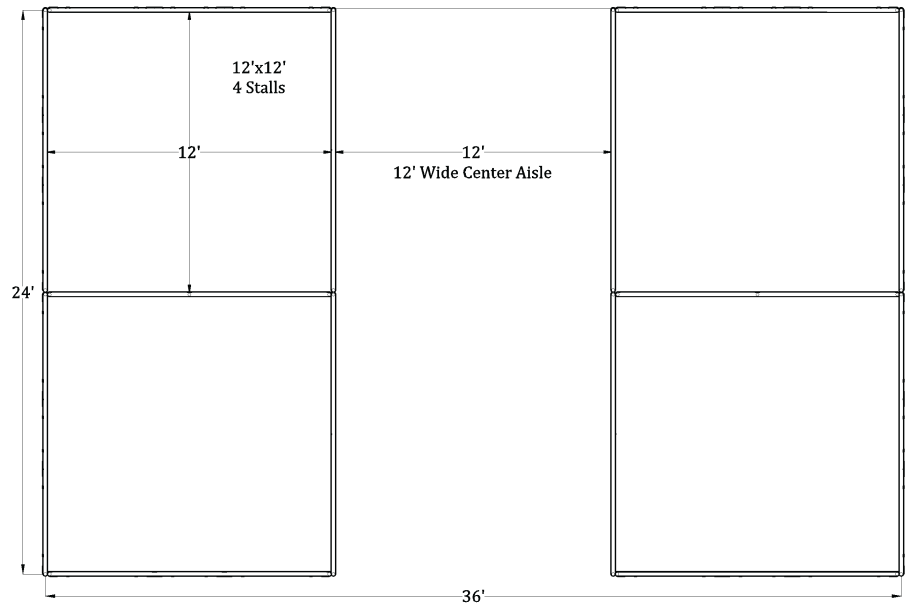

Side View (12'x12', 4 Stall Plywood Ready Barn)

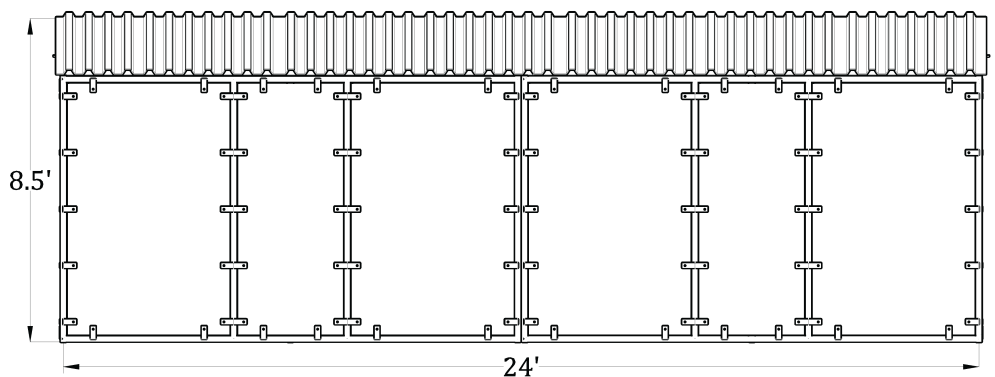

FOX EQUINE BARN

Modular Barns, Shelters & Fencing Solutions

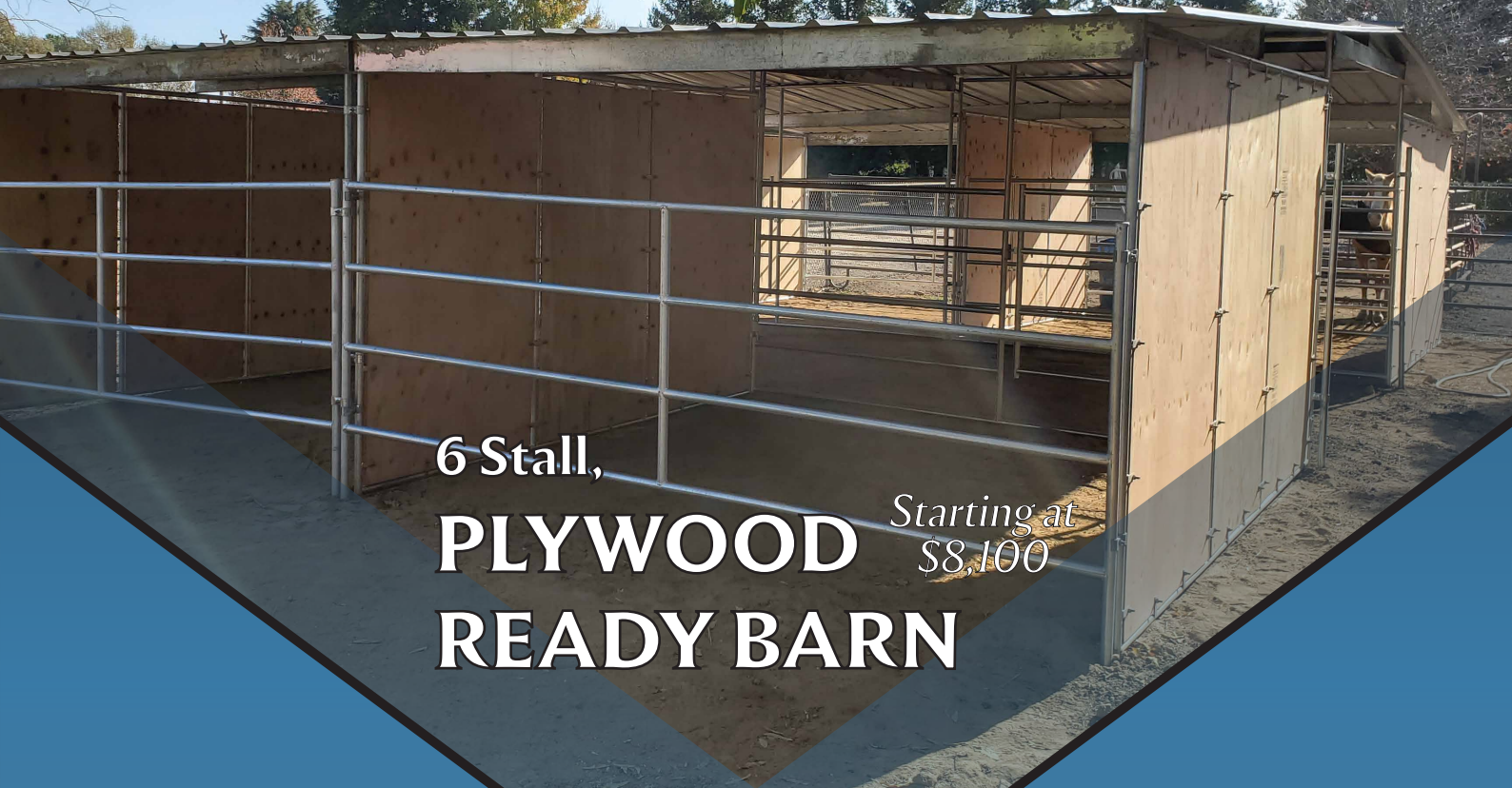

6 Stall,

PLYWOOD READY BARN

Starting at
\$8,100

Paddocks / Runs

5' Tall x 12' Wide 4 Rail Panel
at \$120 each

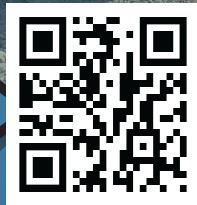

Wind Anchors

7' , 15/8 Galvanized Steel Pole
With Clamps
at \$30 each

Plywood Ready Barns With Covered Aisle

Our standard shelters and barns with plywood ready sides use 12 foot panels that are 7 feet tall that have vertical tubes with tabs welded onto them that the plywood bolts onto with 3/8 inch hardware.

3 sheets of plywood fit recessed inside each bay in the 12 foot wide panel, when they are cut down to 7 feet tall. Each sheet of plywood The panels are made from the same 1 5/8 inch galvanized steel tubing.

Barns & shelters are completely modular so you can always add onto them with additional 12x12 stalls or tack/grain/hay rooms.

Technical Specs

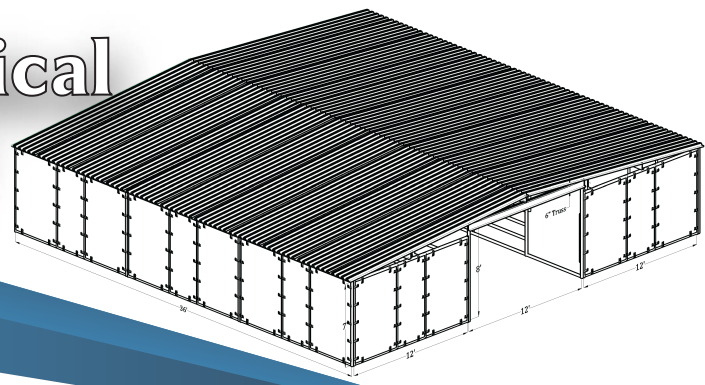

Delivery and complete set up available,

Contact us for a quote

All prices subject to change without notice, prices do not include cost of plywood.

All shelters are free standing unless otherwise requested, wind anchors can be provided at an additional charge.

Unless otherwise requested, all shelters will be installed as pictured.

PROFESSIONALISM

Fox Equine Barns was founded in 2015, when our horse rescue, Fox Equine Rescue & Youth Horsemanship Center, moved and needed fencing and shelters for our 15 rescue horses. We couldn't find what we needed at an affordable price, so we started a business to manufacture and sell livestock shelters, barns, corral panels, round pens, and gates.

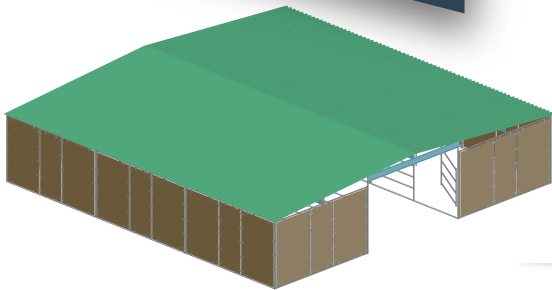

Front Elevation (12'x12', 6 Stall Plywood Ready Barn)

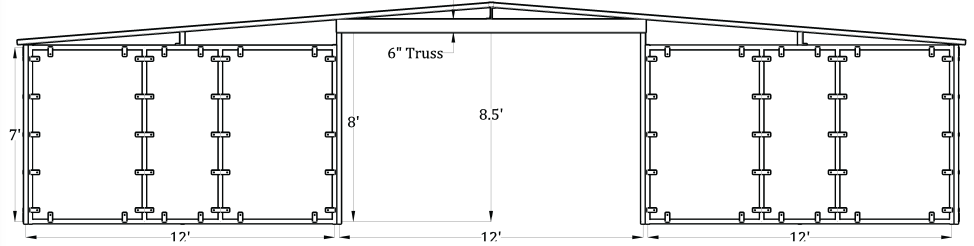

Top View (12'x12', 6 Stall Plywood Ready Barn)
Total Area Covered = 36'x36'

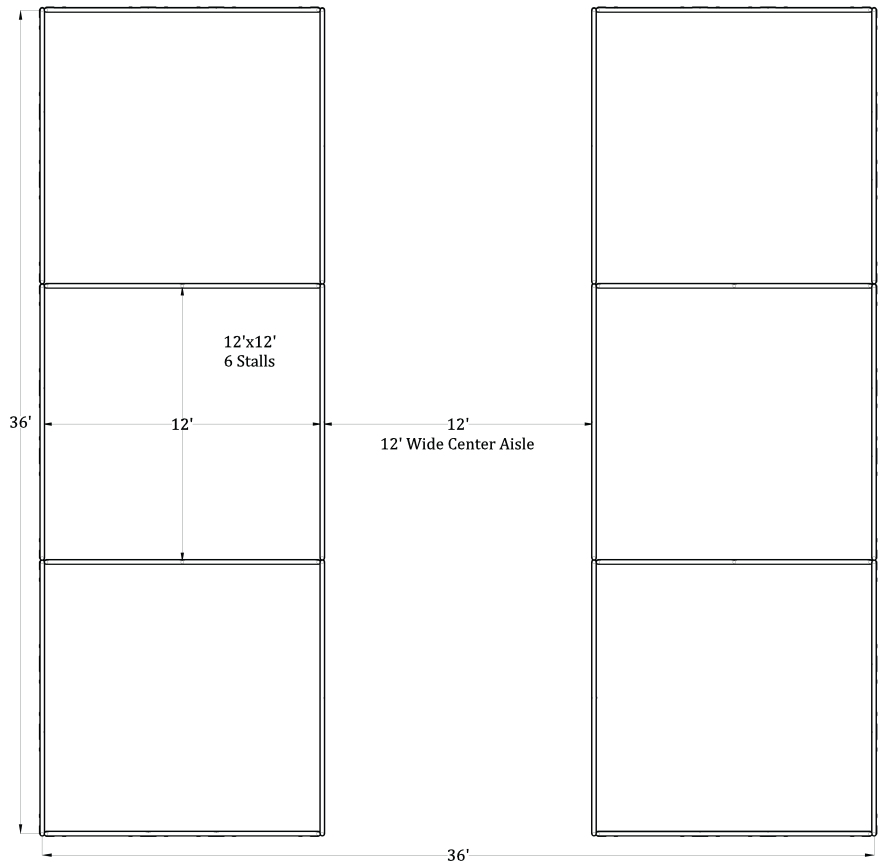

Side View (12'x12', 6 Stall Plywood Ready Barn)

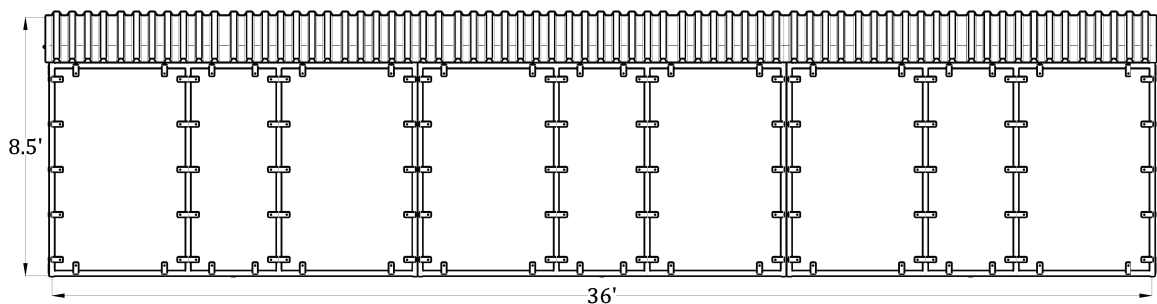

FOX EQUINE BARN

Modular Barns, Shelters & Fencing Solutions



8 Stall,
**PLYWOOD
READY BARN** Starting at
\$10,800

Paddocks / Runs

5' Tall x 12' Wide 4 Rail Panel
at \$120 each

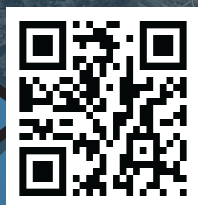

Wind Anchors

7', 1 5/8 Galvanized Steel Pole
With Clamps
at \$30 each

Plywood Ready Barns With Covered Aisle

Our standard shelters and barns with plywood ready sides use 12 foot panels that are 7 feet tall that have vertical tubes with tabs welded onto them that the plywood bolts onto with 3/8 inch hardware.

3 sheets of plywood fit recessed inside each bay in the 12 foot wide panel, when they are cut down to 7 feet tall. Each sheet of plywood The panels are made from the same 1 5/8 inch galvanized steel tubing.

Barns & shelters are completely modular so you can always add onto them with additional 12x12 stalls or tack/grain/hay rooms.

408-416-6602

FoxEquineBarns@gmail.com

<http://foxequinebarns.com/>

Technical Specs

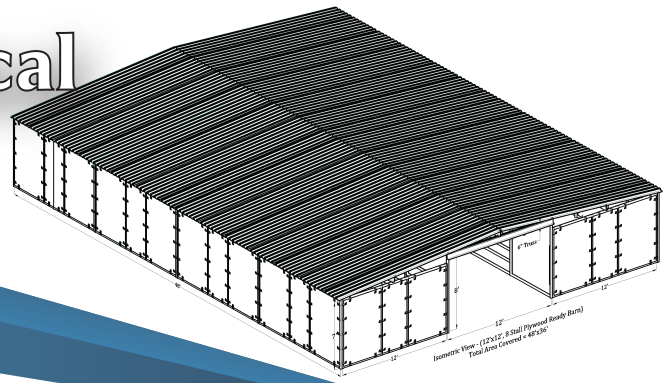

Delivery and complete set up available,

Contact us for a quote

All prices subject to change without notice, prices do not include cost of plywood.

All shelters are free standing unless otherwise requested, wind anchors can be provided at an additional charge.

Unless otherwise requested, all shelters will be installed as pictured.

PROFESSIONALISM

Fox Equine Barns was founded in 2015, when our horse rescue, Fox Equine Rescue & Youth Horsemanship Center, moved and needed fencing and shelters for our 15 rescue horses. We couldn't find what we needed at an affordable price, so we started a business to manufacture and sell livestock shelters, barns, corral panels, round pens, and gates.

Front Elevation (12'x12', 8 Stall Plywood Ready Barn)

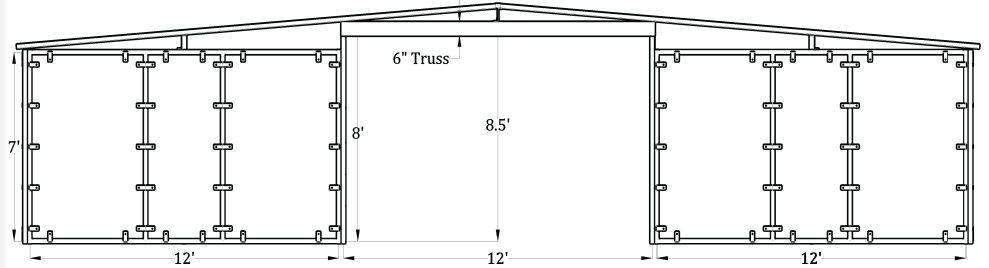

Top View (12'x12', 8 Stall Plywood Ready Barn)
Total Area Covered = 48'x36'

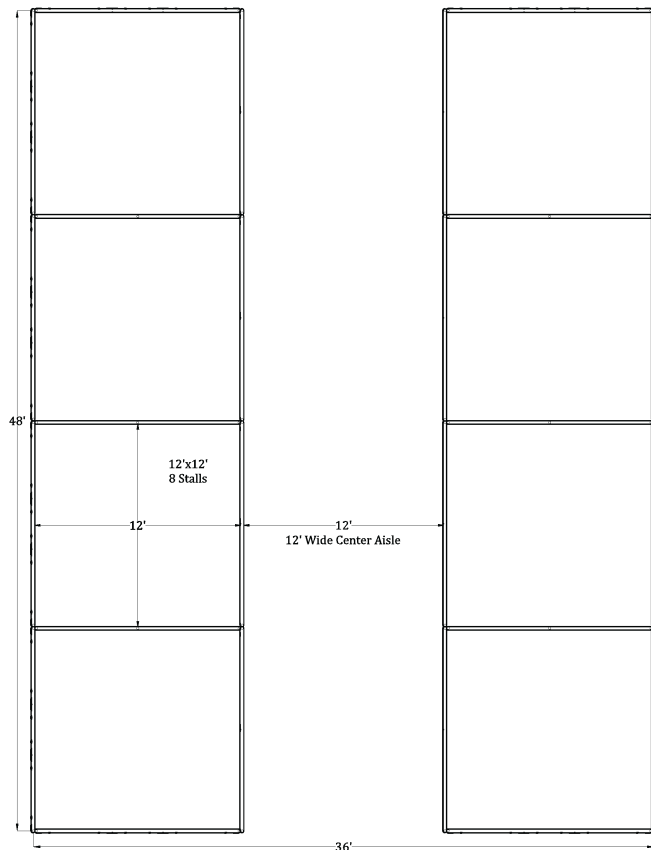

Side View (12'x12', 8 Stall Plywood Ready Barn)

